

# ALUM-A-HOIST



- 10 Year Structural Warranty gives peace of mind
- Permanently Lubricated Pulley Bearings reduce user maintenance
- Maintenance Free no slip chain drive, the heavy duty choice in all large machinery
- Sealed Oil Bath Gear Reducer
- Weatherproof Motor provides extreme reliability
- Patented Wedge Lock cable attachment makes height adjustment easy
- Welded For Structural Integrity in key areas, bolting is limited to components requiring adjustment



For Our Nearest Dealer, Call Toll Free : (800) 545-5603

To learn more about our products , please visit us on the web @ [www.qualityboatlifts.com](http://www.qualityboatlifts.com)



# QUALITY BOAT LIFTS

17030 Alico Center Road, Ft. Myers FL 33967

1-800-545-5603

## SPECIFICATION SHEET..... ALUM-A-HOIST .... 4 POST BOAT LIFTS

	4500	7000	10000	13000
TOP BEAM CHANNEL SIZE	5" X 2.00"	5" X 2.00"	6" X 2.00"	7" X 2.00"
TOP BEAM OVERALL SIZE	5" X 8 3/8"	5" X 8 3/8"	6" X 8 3/8"	7" X 8 3/8"
NUMBER OF BEARINGS	10	10	10	10
GROVED CABLE WINDER LENGTH	2 3/8" DIA. X 16" LONG	2 3/8" DIA. X 16" LONG	2 3/8" DIA. X 19" LONG	2 3/8" DIA. X 19" LONG
DRIVE SHAFT SIZE	1 15/16" O.D. GALV. PIPE	1 15/16" O.D. GALV. PIPE	1 15/16" O.D. GALV. PIPE	1 15/16" O.D. GALV. PIPE
CHAIN SIZE	# 50	# 50	# 50	# 50
DRIVE SHAFT SPROCKET	60 TOOTH	60 TOOTH	60 TOOTH	60 TOOTH
GEAR DRIVE SPROCKET	11 TOOTH	9 TOOTH	11 TOOTH	9 TOOTH
SEALED OIL BATH GEAR REDUCER	60:1	60:1	60:1	60:1
NO. OF MOTORS & HORSE POWER	(2) 3/4 H.P.	(2) 3/4 H.P.	(2) 3/4 H.P.	(2) 3/4 H.P.
MOTOR VOLTAGE & AMPS (PER MOTOR)	120 V 11.4 AMPS 240 V 5.7 AMPS	120 V 11.4 AMPS 240 V 5.7 AMPS	120 V 11.4 AMPS 240 V 5.7 AMPS	120 V 11.4 AMPS 240 V 5.7 AMPS
CABLES	1/4" DIA. 15 FT 1 PART	5/16" DIA. 15 FT 1 PART	1/4" DIA. 30 FT 2 PART	5/16" DIA. 30 FT 2 PART
CABLE SPREAD	66"	90"	90"	114"
SPEED OF LIFT INCHES / MINUTE	40	32	20	16
GUIDE POST HEIGHT	7 FT.	7 FT.	7 FT.	7 FT.
BUNKS	2" x 8" x 12'	2" x 8" x 12'	2" x 8" x 12'	2" x 8" x 12'
PILING MOUNT BRACKETS	T-TYPE, SS, ADJUSTABLE	T-TYPE, SS, ADJUSTABLE	T-TYPE, SS, ADJUSTABLE	T-TYPE, SS, ADJUSTABLE
BOTTOM BEAM SIZE (2X)	5" x 3.5" I-BEAM X 108" LG.	6" x 4" I-BEAM X 120" LG.	7" x 4.5" I-BEAM X 132" LG.	7" x 4.5" I-BEAM X 144" LG.

- ALL MATERIALS 6061-T6 MARINE GRADE ALUMINUM
- ALL HARDWARE 304 STAINLESS STEEL
- HEAVY DUTY 3" ALUMINUM ANGLE BUNK BRACKETS
- 6061-T6 MACHINED ALUMINUM PULLEYS

### PILE SPACING

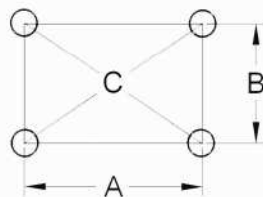

LIFT CAPACITY	A	B	C	RECOMMENDED MIN. PILE SIZE
4500	132"	120"	178"	8" DIA.
7000	144"	144"	204"	8" DIA.
10000	144"	150"	208"	8" DIA.
13000	144"	150"	208"	8" DIA.



For Our Nearest Dealer, Call Toll Free : (800) 545-5603

To learn more about our products , please visit us on the web @ [www.qualityboatlifts.com](http://www.qualityboatlifts.com)